

Applicable Departments

Anesthesiology, ICU, CCU, Cardiac Catheterization Room, Cardiology, Cardiac Surgery, Neurosurgery, Transplantation, etc.

Order Details

Compatible Models	Connector Images	Connector Types	Order Code	Pressure Tubing color	Blood Reservoir	Channel Types	Infusion Velocity	Sterilization	Packing Specification	Validity Period
Abbott		6pin (Round)	XA103R222	Red	✓	Single	3ml/h (±1)	✓	1pcs/bag, 30pcs/box	2 years
			X0046A	Transparency	✗					
UTAH		4pin (Square)	XB103R222	Red	✓	Single	3ml/h (±1)	✓	1pcs/bag, 30pcs/box	2 years
			X0046B	Transparency	✗					
Edwards Baxter		5pin (Round)	XC103R222	Red	✓	Single	3ml/h (±1)	✓	1pcs/bag, 30pcs/box	2 years
			X0046C	Transparency	✗					
BD/Ohmeda		4pin (Round)	XD103R222	Red	✓	Single	3ml/h (±1)	✓	1pcs/bag, 30pcs/box	2 years
			X0046D	Transparency	✗					
Argon MAXXIM		5pin (Round)	XE103R222	Red	✓	Single	3ml/h (±1)	✓	1pcs/bag, 30pcs/box	2 years
			X0046E	Transparency	✗					
B.Braun		4pin (Round)	XF103R222	Red	✓	Single	3ml/h (±1)	✓	1pcs/bag, 30pcs/box	2 years
			X0046F	Transparency	✗					
PVB/SIMMS		5pin (Square)	XG103R222	Red	✓	Single	3ml/h (±1)	✓	1pcs/bag, 30pcs/box	2 years
			X0046G	Transparency	✗					

Provides various interface and adapter cable solutions to meet clinical needs.

Declaration:Shenzhen Med-Link Electronics Tech Co., Ltd. ("MedLinket") hereby declares that all registered trademarks, product names, model numbers, etc., mentioned in the document belong to respective original owners or manufacturers.The information referenced herein is intended to clearly describe the compatibility features of MedLinket products for reference only and should not be construed as an operational guideline for medical institutions or related entities.If any adverse consequences arise from misunderstanding or incorrect use of the information, MedLinket shall not be held liable.

Shenzhen Med-link Electronics Tech Co.,Ltd

Address: Zone A of 1st and 2nd Floor, and 3rd Floor, Building A, No. 7, Tongsheng Industrial Park Road, Shanghenglang Community, Dalang Street, Longhua District, 518109 Shenzhen, PEOPLE'S REPUBLIC OF CHINA

Tel: +86-400-058 0755 /+86-0755-61120299

Email: marketing@med-linket.com



Disposable IBP Transducer

(Fully Closed Blood Sampling System)



Excellent Details, Trustworthy Choice

Product Advantages



Compact Mounting Plate & Pole Clamp

- The sensor can be placed to meet the specific needs of the clinical scenarios.
- The mounting plate is compact, space-efficient, and facilitates convenient operation.



High Quality Flush Device

- Humanized design allows one-handed operation and excellent tactile feedback.
- Post-collection, residual blood in the tube is rapidly flushed (1ml/s), saving time and minimizing pressure measurement errors.

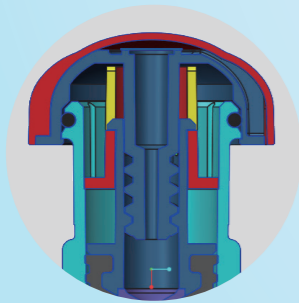

Closed System of Blood Reservoir

- The fully closed design blocks microorganisms from entering the blood reservoir and prevents adhesion on tube walls, avoiding cross-contamination.
- The reservoir's large base and rotatable design enable standardized operation to prevent air embolism.

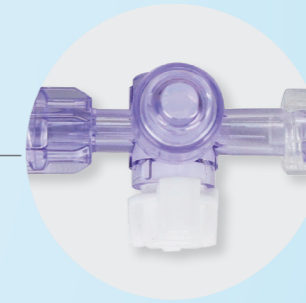

Convenient Three-way Valve

- The fully closed blood sampling system allows for needleless blood sampling enhancing clinical efficiency and safety.
- Premium imported silicone material, easy to clean, wipe, and disinfect.

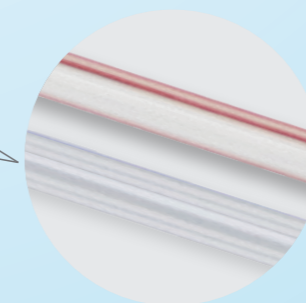

Color-coded Pressure Tubing

- Reduces the risk of tubing connection and medication errors, effectively preventing medical accidents.
- Simplifies complex tubing management, enhancing medical workers efficiency.

